

OT803L Thermal Receipt Printer

User Manual



Otpos Technologies Inc
www.otpos.com

Packing

- 80mm Thermal Receipt Printer x1
- AC adapter with one AC cable power cord x1
- USB 2.0 Printer Cable - A-Male to B-Male Cord for USB port x1
- RJ45 Cat-6 Ethernet Patch Internet Cable for LAN port x1
- Serial Data Cable x1
- User's Manual x1
- 80mm Paper Roll x1
- Flash Disk Driver x1

Features

- 260mm/s high printing speed.
- Support kitchen, network printing.
- 80 large capacity paper houses.
- High speed text and graphic printing, Excellent printing quality and reliable performance.
- Support printer status monitoring function, Control printer's status at any time.
- Receipt coming alarm and error alarm reminder.
- Driver high speed download printing mode, Support Linux system.
- Support black mark detection and oertype function.
- Support 256k Bytes NV logo download store and print.
- Serial + USB + Lan interface.
- Better sealing performance for mechanism and printer, Mechanism life can reach to 150km and Auto cutter life with 1.5 million cuts.
- Support QR Code, PDF417 Printing
- Support Chinese GB18030.
- Multiple international can be optional, Chinese are convertible by command.
- Built in web page, Setup printer directly through web browser.

Connection

- a. Connect AC power cord to power, DC power cord to printer.
- b. Connect printer and computer/ tablet.
- c. Connect cash drawer.

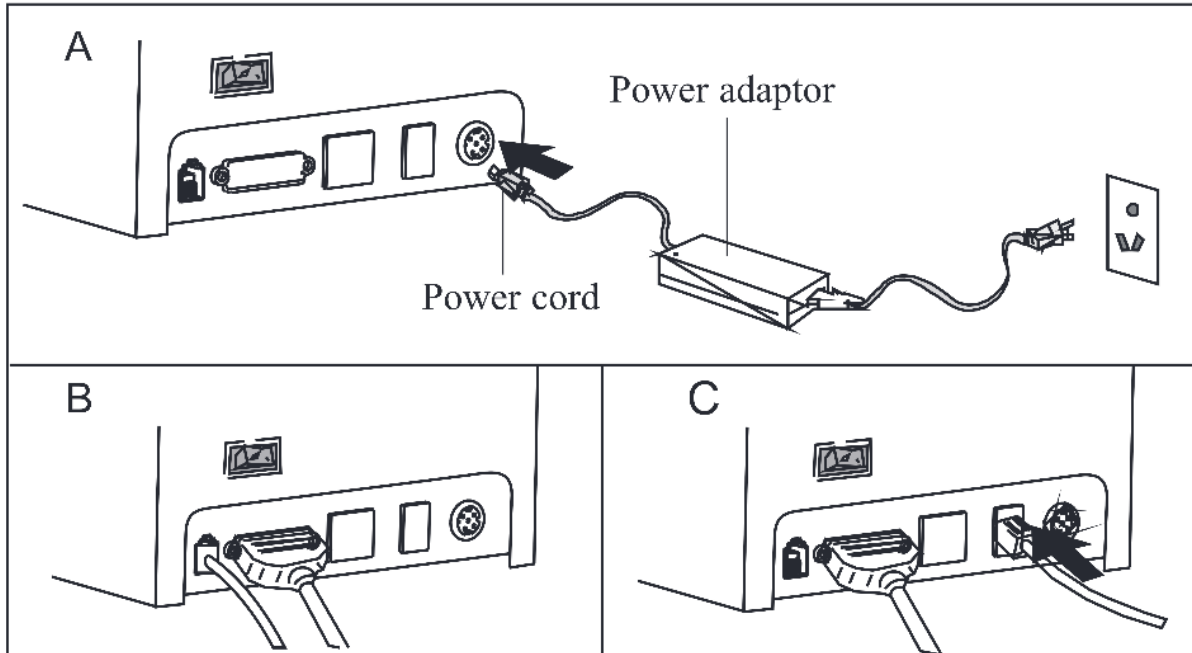

Paper roll loading

80mm thermal paper roll recommended to 80mm series printers. The method of paper loading is as below:

- a. Open top cover
- b. Drop paper roll in the hole as below
- c. Pull the paper into the paper holder, then close to cover
- d. Print one self-test to make sure paper correctly installed.

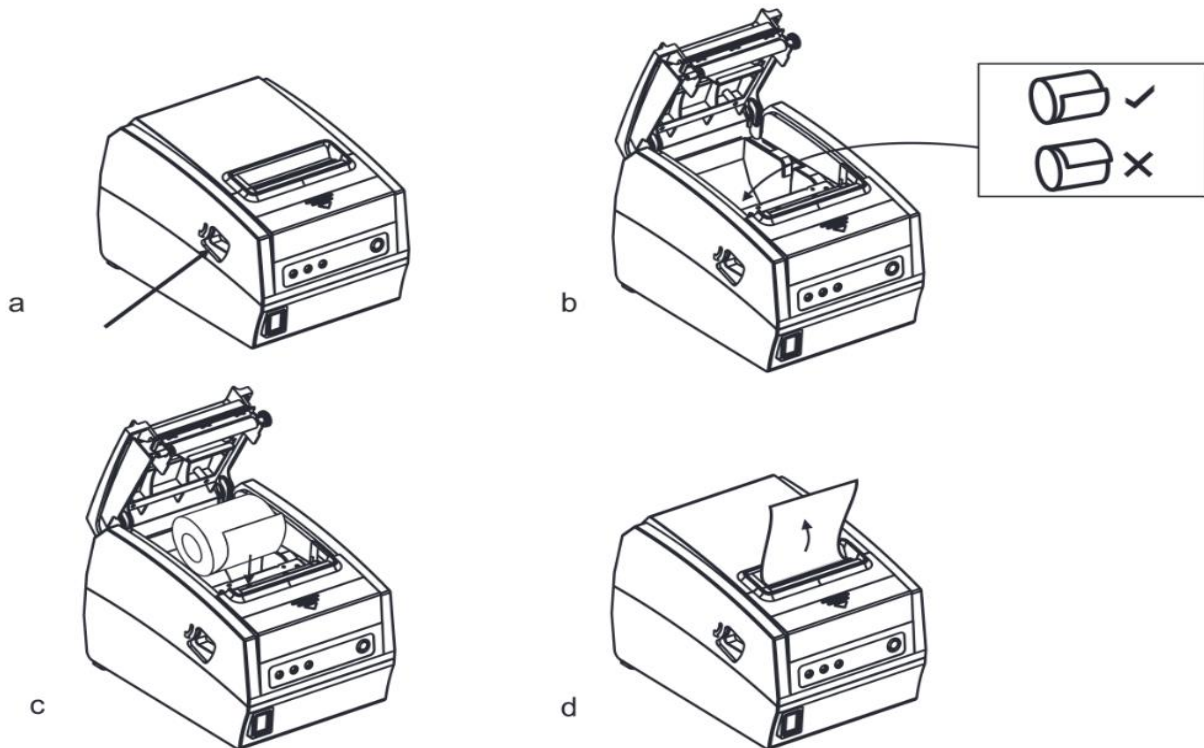

Button name, indicator LED light and function

(1) FEED button

Press to FEED paper manually.

(2) Paper indicator (LED light)

Blue and red light are on means lack of paper; no alarm means all goes well.

(3) Power indicator

Light is on means connected properly.

(4) Error button

When out of paper, cutter error or printing head overheat occurred, the ALARM indicator twinkles.

Self-Test

Method: When printer is connected power, turn off, press "FEED" button and turn on at the same time, 2 seconds later release "FEED" button, a completed self-test will be printed out to show printer settings.

Method to enter hexadecimal mode

Method: When printer is connected power, press "FEED" button and turn on at the same time for about 10 seconds, release "FEED" button to enter data hex dump mode. it will print "Hexadecimal Dump" on the paper.

Reset

Method: When printer is connected power, press "FEED" button and turn on at the same time for about 20 seconds, reset succeed if beeper peals.

How to solve paper jam

(1) Method 1

Re-start printer.

(2) Method 2

Open the battery cover near paper exit. Turn the white gear on the cutter. Only the cutter back to initial position, can the cover be opened.

Caution: Do not damage the printhead and auto cutter by open the cover forcibly.

Cautions:

- (1) Be sure to install your printer on a stable surface and prevent it from vibration and impact.
- (2) Do not use and store in locations subject to high temperature humidity or pollution levels.
- (3) Connect the power adapter into a properly grounded outlet. Do not share the same plug socket with large-scale electrical motor or other motors which may cause the power supply voltage fluctuations.
- (4) Avoid water or other conducive materials like metal get into the intern of printer. If it happens unplug the AC power cord immediately.
- (5) Do not print without paper or it will damage the rubber roller and thermal printhead.
- (6) Unplug your printer before leaving it unused for an extended period. (
- 7) Never disassemble or modify the printer for repair or reconstruction.
- (8) Be sure to use the original specified power source.
- (9) Quality roll paper is recommended for premium printing and product maintenance.
- (10) Be sure to turn the product off when plugging and unplugging.
- (11) Place the plug socket around the product for convenience.
- (12) This product is used only below 5000 meters above sea level in tropical climate conditions.

Clearance

Timely clean the printhead if one of the below conditions occurred :

- (1) Unclear printing.
- (2) Unclear vertical column in printing paper.
- (3) Noisy feeding.

Cleaning steps are as follows :

- (1) Turn off the printer and open the roll paper cover. Remove the roll paper if any.
- (2) After printing the thermal head can be very hot. Wait to let it cool before cleaning.
- (3) Clean the thermal elements of the thermal head with a wrung -out cotton moistened with an alcohol solvent.
- (4) Wait till the ethanol completely volatilized to close cover. Then print self-test page.